

VIERRE

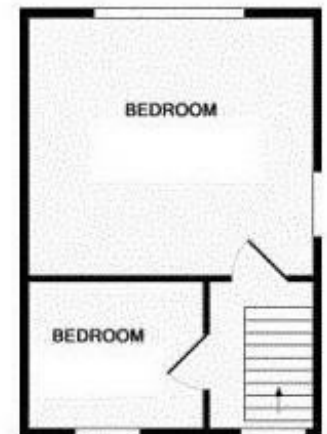

ST MARY'S VILLAS
LEADING TO
ABBOTS CLOSE
AND
KINGSDALE CLOSE

5 Clive Villas, Battle Hill, Battle, TN33 0BX

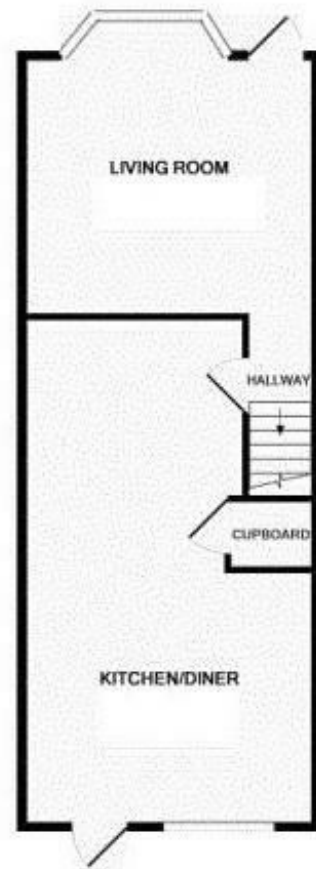

5 Clive Villas, Battle Hill, Battle, TN33 0BX

£1,650 Per month

- End of Terrace House
- Spacious Living
- Private Garden
- Unfurnished
- 4 Bedrooms
- Convenient Location
- Council Tax Band C

A spacious and well-presented four-bedroom property available now, located within the desirable Clive Villas area of Battle. Offering generous accommodation throughout, this attractive home provides plenty of space for families, professionals, or those simply looking for flexible living arrangements.

The property benefits from well-proportioned rooms, creating a bright and comfortable living environment with ample space for both relaxing and entertaining. The versatile layout offers flexibility to suit a variety of lifestyles, with four good-sized bedrooms providing comfortable accommodation throughout.

Conveniently positioned within easy reach of local amenities, schools, shops, and transport links, the property enjoys a sought-after location while offering the charm and convenience of living in Battle.



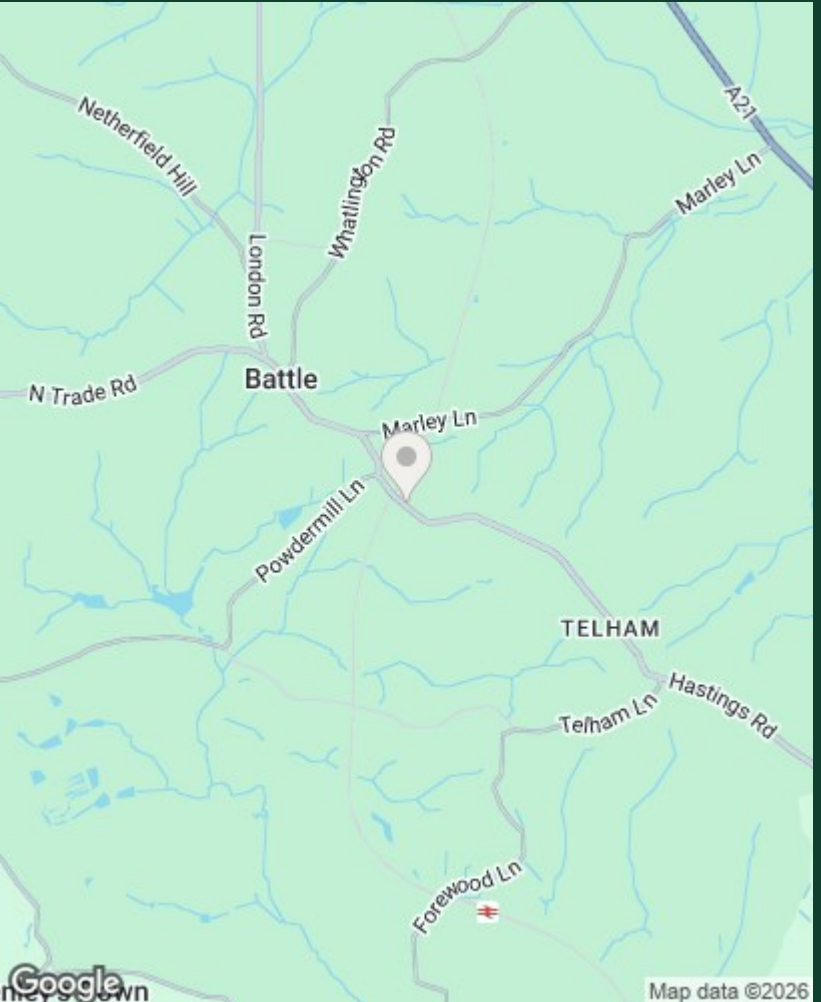

Energy Efficiency Rating

	Current	Potential
Very energy efficient - lower running costs		
(92 plus) A		
(81-91) B		
(69-80) C		
(55-68) D		
(39-54) E		
(21-38) F		
(1-20) G		
Not energy efficient - higher running costs		
	50	

England & Wales EU Directive 2002/91/EC

Environmental Impact (CO₂) Rating

	Current	Potential
Very environmentally friendly - lower CO ₂ emissions		
(92 plus) A		
(81-91) B		
(69-80) C		
(55-68) D		
(39-54) E		
(21-38) F		
(1-20) G		
Not environmentally friendly - higher CO ₂ emissions		

England & Wales EU Directive 2002/91/EC